



RGS REBAR

Version 4.0.20.20

Release Date – 13 JULY 2023

New Features

1. RRCP – 1001 / QG2 – 1456 Usage of single line and double line blocks added.

Step 1 Place the Block files in the following location with file format name renamed with underscore character and Double line (ex. ACI 315_99_DL)

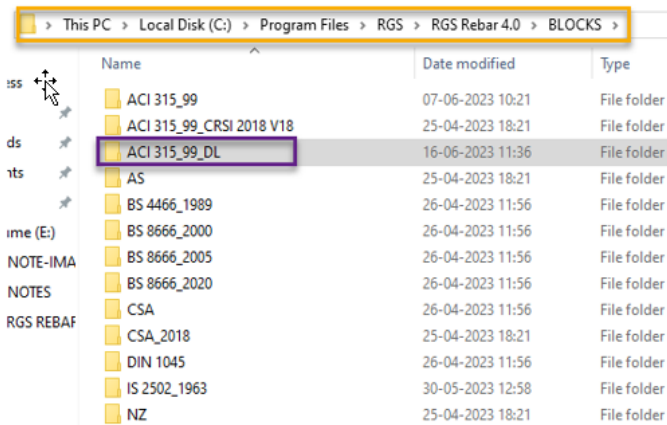

Step 2 Choose the option **Use Double line blocks** in Bar bending schedule box and then place Bar bending schedule.

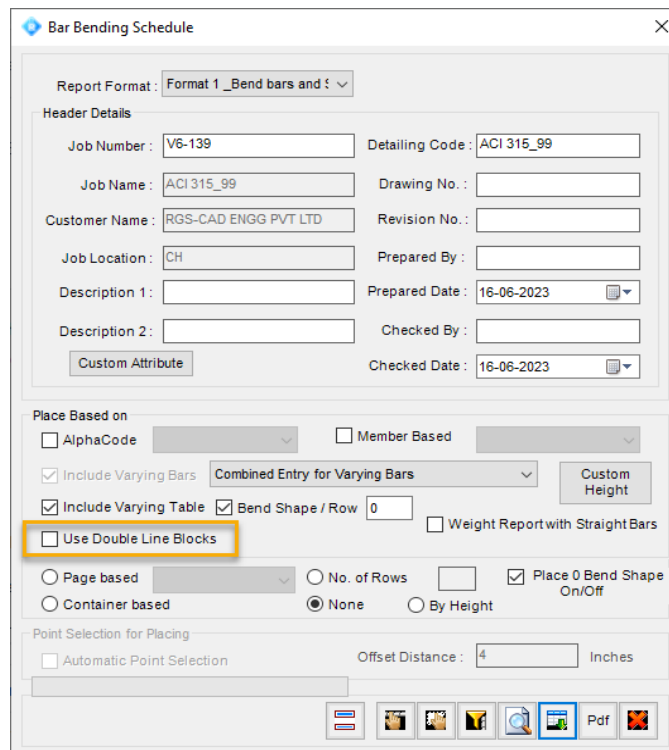

a. Arrangement of Bend shape blocks by table format.

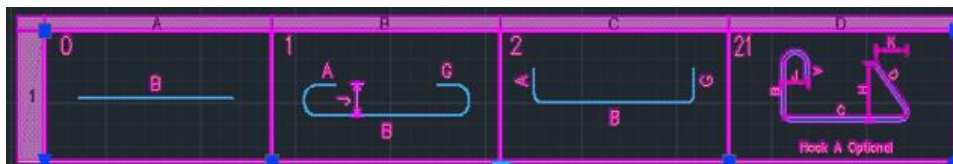

2. RRCP – 473 / QG2 – 353 Use command “POINTCLEANUP” to remove Point Style issue.

3. RRCP – 1185 / QG2 - 1725 New format for drawing weight added based upon drawing grade & bar size with total weight.

The screenshot shows the 'Drawing Weight Report' dialog box with the following data:

Weight based on :		Black Bars		Coated Bars		
Color	Control Code	Description	Weight(in lbs)	Weight(in Tons)	Weight(in lbs)	Weight(in Tons)
	---		857	0.43	0	0

Summary values from the dialog:

	Black Bars	Coated Bars	Total
Total Weight (in lbs)	857	0	857
Total Weight (in Tons)	0.43	0	0.43

The 'Place Weight for Drawing' section includes buttons for 'Control Codes Weight', 'Sheet Weight', 'Release Weight', 'Grades & Barsize', 'Weight Summary', 'Selected Control Code', 'Release No and Coats', and 'Bend Category'. The 'Grades & Barsize' button is highlighted with a yellow box.

Summary tables on the right:

WBGHT REPORT - T1	
GRADE : 60 (BLACK)	
SIZE	WEIGHT IN LBS
#5	37.87
#6	35.64
#7	29.77
#10	574.45
#18	132.6
TOTAL	810.33

WBGHT REPORT - T2	
GRADE : 60 (BLACK)	
SIZE	WEIGHT IN LBS
#6	46.56

TOTAL WEIGHT : 857 lbs

Improvement

1. Search option added in rebar notes textbox at Rebar entry form.

The screenshot shows the 'RGS Rebar -> Rebar Entry' form with the following details:

Bend Shape : 1 (selected from dropdown: AUTO, 0, OHT1, OHT2, 1, 1A, 2, 2A)

Bar Label Data: Places Layer: 1, Quantity: 1, Notation: #, Grade: A615-60, Coating: Black, Size: 5, Prfx: A, Mark: , Spacing: 12

Bar belongs to...: Element Mark: UNASSIGNED, Release: UNASSIGNED, Drawing: , Bid Item: UNASSIGNED, Control Code: UNASSIGNED

Notes... (highlighted with a yellow box): b, B1, B2, B3, B4, BOT.

Dimensional Data: Bar Length: Theoretical: , Cut: , Couplers... (button)

Buttons: Draw Bar, Close, Clear

Footer Info: Grade : A615-60 Coating : Black, LE : None, RE : None

Bug

1. QG2 – 1587 Rotation of varying bar bug solved. – **Fixed.**
2. RRCP – 1117 / QG2 – 1582 Varying bar callout mismatch – **Fixed.**
3. RRCP – 1094 / QG2 – 1500 Donut missing in multi range - **Fixed.**
4. RRCP – 546 / QG2 – 537 Global bar mark change issue - **Fixed**
5. RRCP – 49 / QG2 – 106 Redraw option mirror bar views – **Fixed.**
6. RRCP – 1073 / QG2 – 1390 Bar mark swap problem – **Fixed.**
7. RRCP – 1092 / QG2 - 1487 Callout reposition disappears while using delete option - **Fixed.**
8. RRCP – 929 / QG2 – 947 Rebars mirrored from its Range issue – **Fixed.**
9. QG2 – 1606 / QG2 – 1605 Quantity rounding problem - **Fixed.**
10. RRCP – 1091 / QG2 – 1492 Bar size automatically changing from #5 to #6 issue - **Fixed.**
8. RRCP – 1074 / QG2 – 1392 Find callout or bar problem solved. - **Fixed.**
9. RRCP – 1122 / QG2 – 1605 Quantity rounding by using command problem - **Fixed.**
10. RRCP – 1118 / QG2 – 1591 While copying varying bar, bar mark suffix missing - **Fixed.**
11. RRCP – 397 / QG2 – 1073 View changing bars are not mirrored from their original position problem - **Fixed.**
12. RRCP – 167 / QG2 – 238 Bars / Callouts if updated / redrawn after detailing, positions misplaced or rotating for rotated / mirrored bars copied from other bars issue - **Fixed.**
13. RRCP – 707 / QG2 – 558 Bar View Rotates while Redraw the callouts issue - **Fixed.**
14. RRCP – 1151 / QG2 – 1664 Sometimes in force close of application getting error message and sometimes without a warning. the application shuts suddenly - **Fixed**